

Interior and front door handles for DIN lockcases

Bearing:

Regardless of the type of rose, all handles have a nylon bearing between the rose and the neck of the handle. As the roses around the neck of the handle are not fixed to the neck, the handle is fixed to a special spindle with a retaining screw (except handles with 004-rose).

Packing:

Handles are normally delivered in D.I.Y packages.

Screws and door thickness

Roses are fixed with M4 or M5 X-head countersunk screws and threaded sleeves. More specific door thicknesses are in the table. If the door is thicker, thickness must be specified in the order.

DIN-HANDELS			
Handle	Rose	Door thickness	Special spindle
27	002	30-60	100
6, 133	002	30-60	100
110	010 002	30-60	100
		30-60	100
2,22 3-16 and 3-16s	002	34-57	100
3-20	002	38-80	120

3-18 3-18s 3-20	015 (no nylon bearing)	29-45	fixed spindle
-----------------------	---------------------------	-------	---------------

4 Zn	004	35-40	100
20 Zn	004	35-40	105
365 Zn	004	35-40	72



BB



BL



PZ



WC

Stainless steel handles 3-18/015, 3-18s and 3-20/015 are delivered as standard for 35-60 mm thick doors. If the thickness of the door is other than standard, it must be specified in the order.

Spindles:

The handles are fitted with an 8 mm special spindle, which is made of galvanized steel. By special order we can deliver handles with a divided spindle; orders of this kind must always be agreed on in advance.

Roses:

Depending on the use, there are two different roses suitable for the handles. The number of the

escutcheon is always the same as that of the rose, for example 019BB. The symbols representing the escutcheons can be seen in the margin.

015 has base plates of steel and the cover plates are made of stainless steel; screw heads are invisible. Only for use with stainless steel handles 3-18, 3-18s and 3-20.

010 is a massive longplate made of cast brass, available with standard key holes (PZ, BB and CH). Also available with turning-knob function for lavatory doors, or with a handle hole only (BL).

The 002-plate includes plastic under-plates and brass cover-plates that conceal screws. The thickness of the plate is 8 mm. Ordinary keyholes PZ and BB can be used in this plate. The plate is also available as a cover-plate P or with toilet doorknob facility.

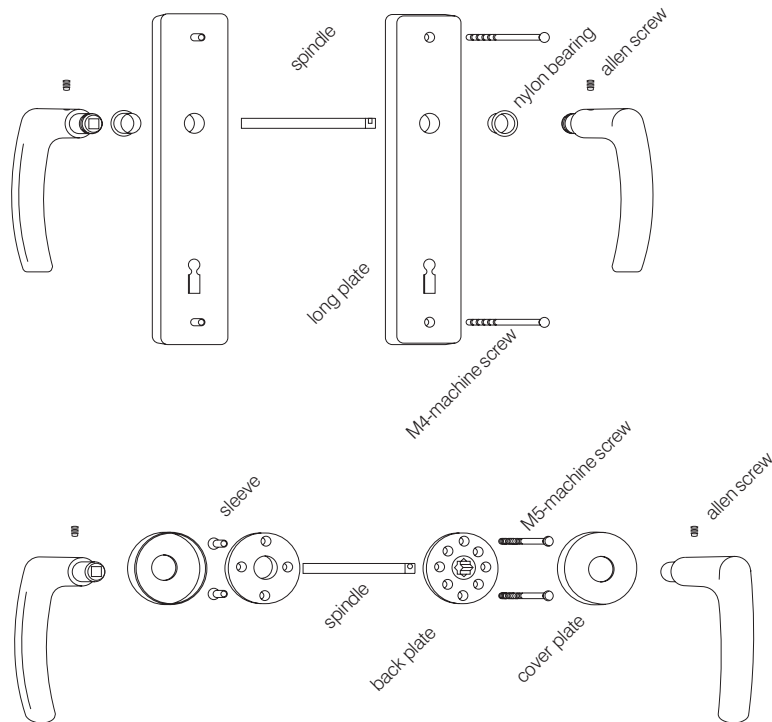

Parlament 2/002/950

Material: brass.

Surface finishes: chrome, satin chrome, polished.

For use with interior doors, including public premises.

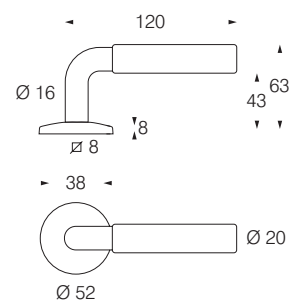

Parlament 22/002/950

Material: brass.

Surface finishes:

chrome/satin chrome/ plated/
polished/white/black/
blue/red. Different parts of
the handle can be obtained
with different finishes according
to the table below.

For use with interior doors,
including public premises.

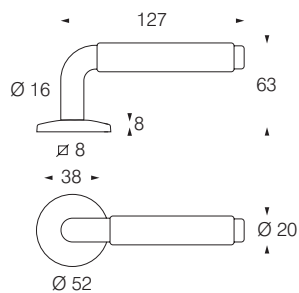

	Rose	Stem	Handle	Knob
Polished brass	•	•	•	•
Chrome	•	•	•	•
Satin chrome	•	•	•	•
Powder-painted	•		•	

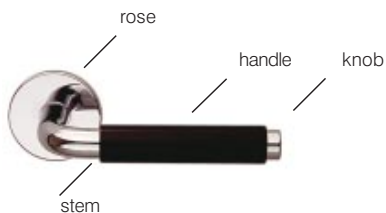

Presto 3-16/002/950

Material: brass.

Surface finishes: polished, chrome, satin chrome.

For use with interior doors, also for public premises.

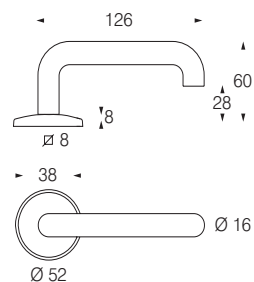

Presto 3-16s/002/950

Material: brass.

Surface finishes: chrome, satin chrome, polished.

For use with interior doors, also for public premises.

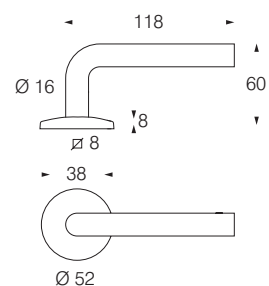

Presto 3-20/002/950

Material: aluminium.
Surface finishes: silver-anodized.

For use with interior and front doors, including public premises.

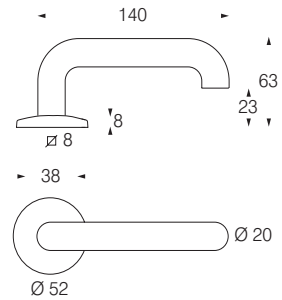

Presto 3-18/015

Material: stainless steel.

For use on public premises.
Standard delivery of a pair of handles is for 40-60 mm thick doors.

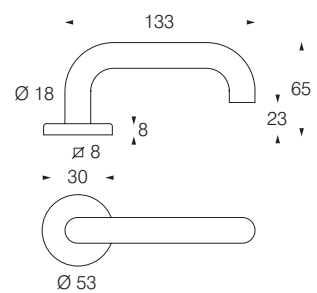

Presto 3-18s/015

Material: stainless steel.

For use on public premises.
Standard delivery of a pair of handles is for 40-60 mm thick doors.

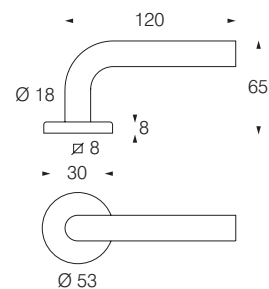

Presto 3-20/015

Material: stainless steel.

For use on public premises.
Standard delivery of a pair of handles is for 40-60 mm thick doors.

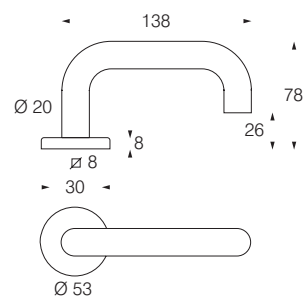

Forum 4/004

Material: zinc

Surface finishes: chromed Zn/CR.,
white ZN/JVA, golden-lacquered
Zn/KULA.

Used in interior doors. Standard
delivery for 35-40-mm-thick doors.

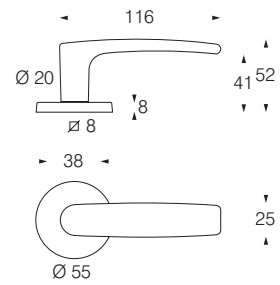

Polar 6/002/950

Material: brass

Surface finishes: polished Ms/KILA, chromed Ms/CR, satin chromed Ms/MCR.

Used both in interior and exterior doors, also in public premises.
Standard delivery for 30-60-mm doors.

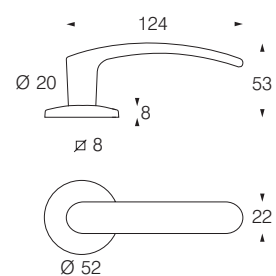

Pohjola 27/002/950

Material: brass

Surface finishes: polished Ms/KILA, chromed Ms/CR, satin chromed Ms/MCR.

Used in both interior and exterior doors, including those of public buildings.

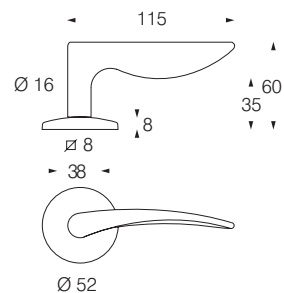

Consul 110/010

Material: brass.

Surface finishes: polished, chrome, satin chrome, satin brass.

For use with interior and front doors, including public premises.

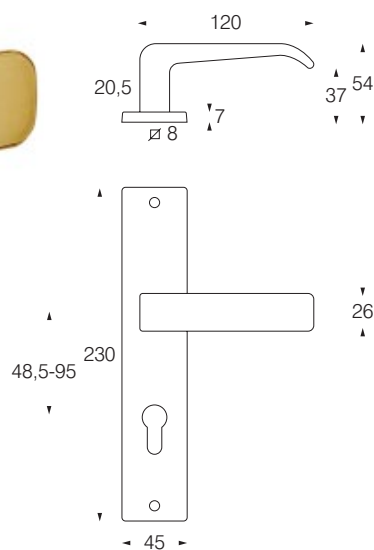

Akatemia 133/002/950

Material: brass.

Surface finishes: polished, chrome, satin chrome.

For use with interior and front doors, including public premises.

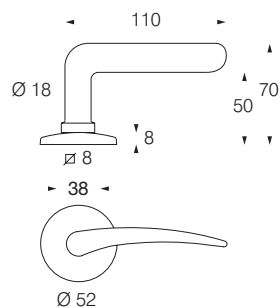

18/011

(PZ, BB, A, WC)

Material: steel/zinc.

Surface finishes: chrome, satin chrome, golden-lacquered.

Includes a return spring and is used in interior doors. Standard delivery for 35-54 mm thick doors.

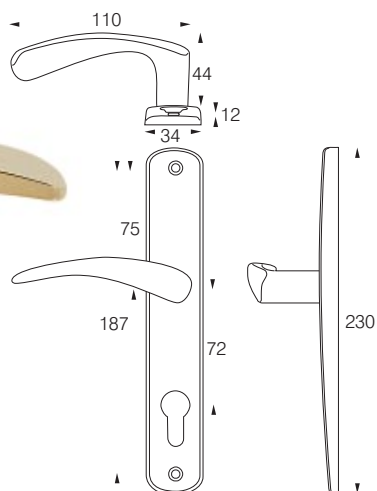

Line 20/004

Material: zinc.

Surface finishes: chromed Zn/CR, white ZN/JVA, golden-lacquered Zn/KULA.

Used in interior doors. Standard delivery for 35-40-mm-thick doors.

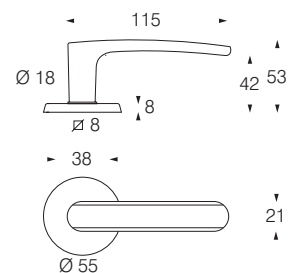

DH365/004

Material: zinc.

Surface finishes: chromed Zn/CR, white ZN/JVA, golden-lacquered Zn/KULA.

Used in interior doors. Standard delivery for 35-40-mm-thick doors.

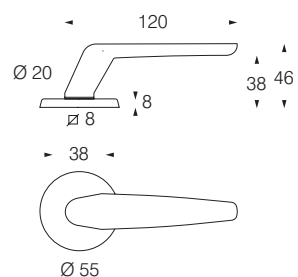

Escutcheon 004

(PZ, BB)

Material: steel.

Surface finishes: chromed Fe/CR, white Fe/JVA, golden-lacquered Fe/KULA.



Ø 55

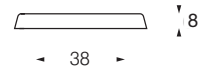

38

8

Turning knob 004 WC

Material: steel.

Surface finishes: chromed Fe/CR, white Fe/JVA, golden-lacquered Fe/KULA.

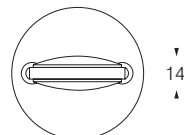

Ø 55

14



38

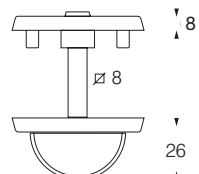

8

∅ 8

26

Escutcheon 002 PZ

Material: brass

Surface finishes: polished Ms/KILA,
chromed Ms/CR, satin chromed
Ms/MCR.



Escutcheon 002 BB

Material: brass

Surface finishes: polished Ms/KILA,
chromed Ms/CR, satin chromed
Ms/MCR.



Cover-plate 002 P

Material: brass

Surface finishes: polished Ms/KILA, chromed Ms/CR, satin chromed Ms/MCR.

Used with interior door lock ABLOY 4195 or equivalent.

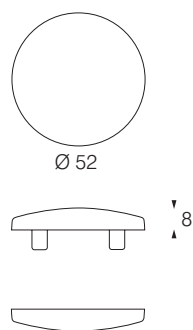

Turning knob 002 WC

Material: brass

Surface finishes: polished Ms/KILA, chromed Ms/CR, satin chromed Ms/MCR.

This knob fits locks with a 90-degree turning range. As a standard, they are delivered to fit 40-mm doors. It has been ensured that it is possible to open locks equipped with this knob from the outside. They are used in bathroom and toilet doors, including those of public buildings.

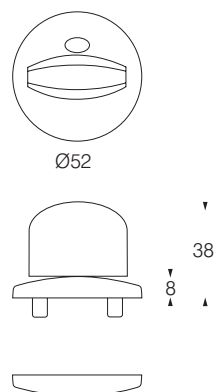

Escutcheon 015

(PZ, BL)

Material: stainless steel.



Ø 53

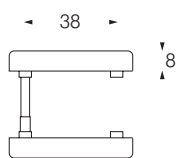

Turning knob 015 WC

Material: stainless steel.

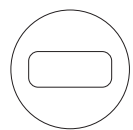

Ø 53

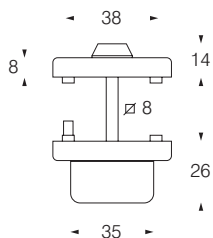

Escutcheon 0545 PZ

Material: stainless steel.

For use with a metal profile door lock.

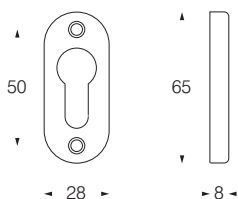

Longplate 010

(TBL, BL, CH, BB, PZ, WC)

Material: brass.

Surface finishes: polished, satin chrome, satin brass.

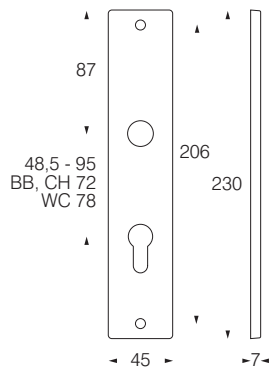

Longplate/knob 115/010

(PZ, BL)

Material: brass.

Surface finishes: polished, satin chrome, satin brass.

